

53279872



Atrium Health

Bringing a sense of place and scale to Health and Well-Being

The 'Strata' design of the new Atrium Union West Hospital embodies the many layered history of Stallings, North Carolina, a small farming town in transition to a bedroom community for metropolitan Charlotte. Its broad, three-story composition and earth-toned materials are inspired by the agrarian context and reduce the perceived scale of the hospital, helping it communicate with its surrounding community.

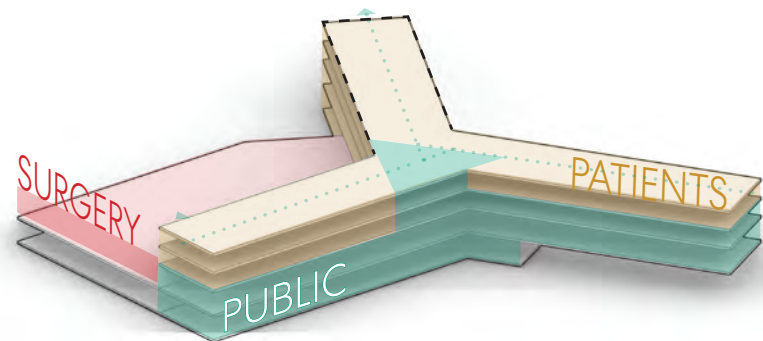

The 'Prototype'

A new standardized model for patient care units prescribes narrower, end-loaded patient wings enhancing patient visibility and response time, reducing staff while all maximizing natural daylighting and views.

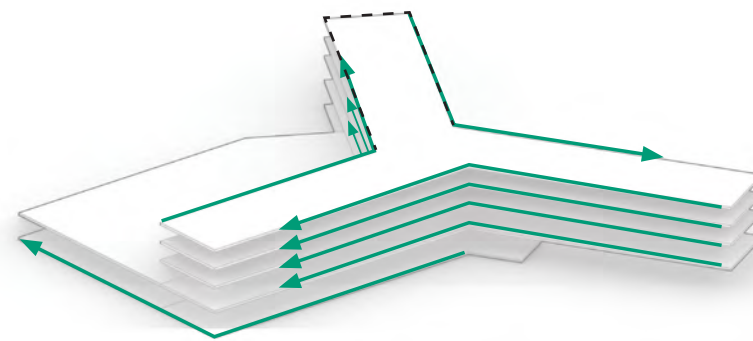

Contextual Relationship

Composing the structure to a sensible scale to communicate with its surrounding context. The 'Strata' reflects that of Stallings 'Many Layered' history, a beacon that serves as the local communities hub for Health & Well-Being.

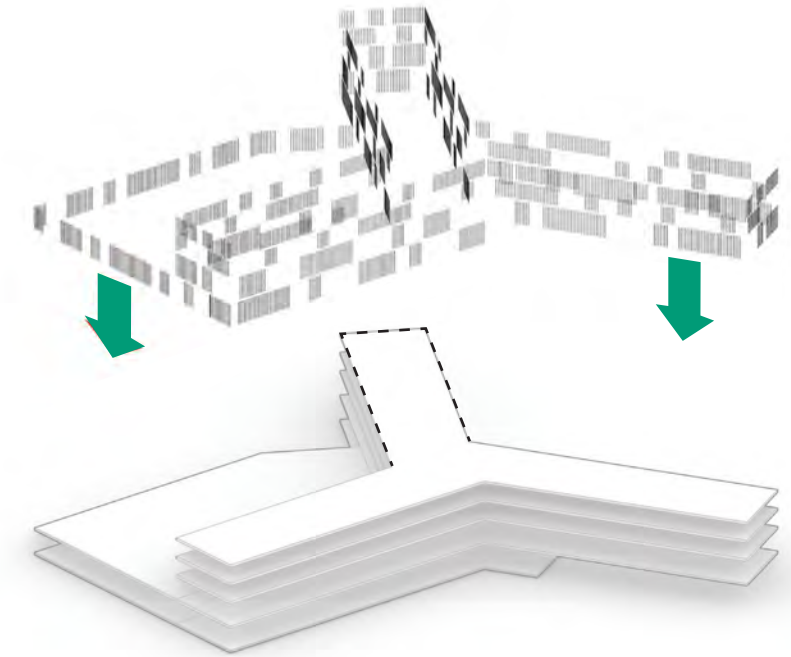

Textured Poetics

Reflecting the Town of Stallings Agrarian past through furrowed landscapes and textured facades forming a healthcare experience that is unique, one that has a 'sense of place'

SITE PLAN

The overall form of the new hospital is derived from the client's standardized model for patient care units. It prescribes narrower, end-loaded patient wings with a more open, centralized nursing commons. This standard permitted a pinwheel arrangement around a central atrium lobby.

- 1 48 Bed Hospital (Day One)
- 2 Hospital Expansion (156 Total Beds)
- 3 Main Entry Plaza
- 4 ED Entry (Lower Level)
- 5 Medical Office Building O1
- 6 Medical Office Building O2 (Future)
- 7 Central Energy Plant
- 8 Parking Deck (Future)
- 9 Green Roof (Future)
- 10 Terraced Garden
- 11 Bridge Connector (Overhead)
- 12 Staff Garden
- 13 MOB Plaza
- 14 Future Development



FLOOR PLAN - LEVEL 01

- 1 Entry Plaza
- 2 Atrium Lobby
- 3 Food Court
- 4 Outdoor Dining
- 5 Garden Lobby Below
- 6 Intensive Care Unit
- 7 Future Green Roof
- 8 Future Bed Tower
- 9 MOB Entry Plaza
- 10 MOB Waiting Area
- 11 MOB Shell Space
- 12 Staff Garden

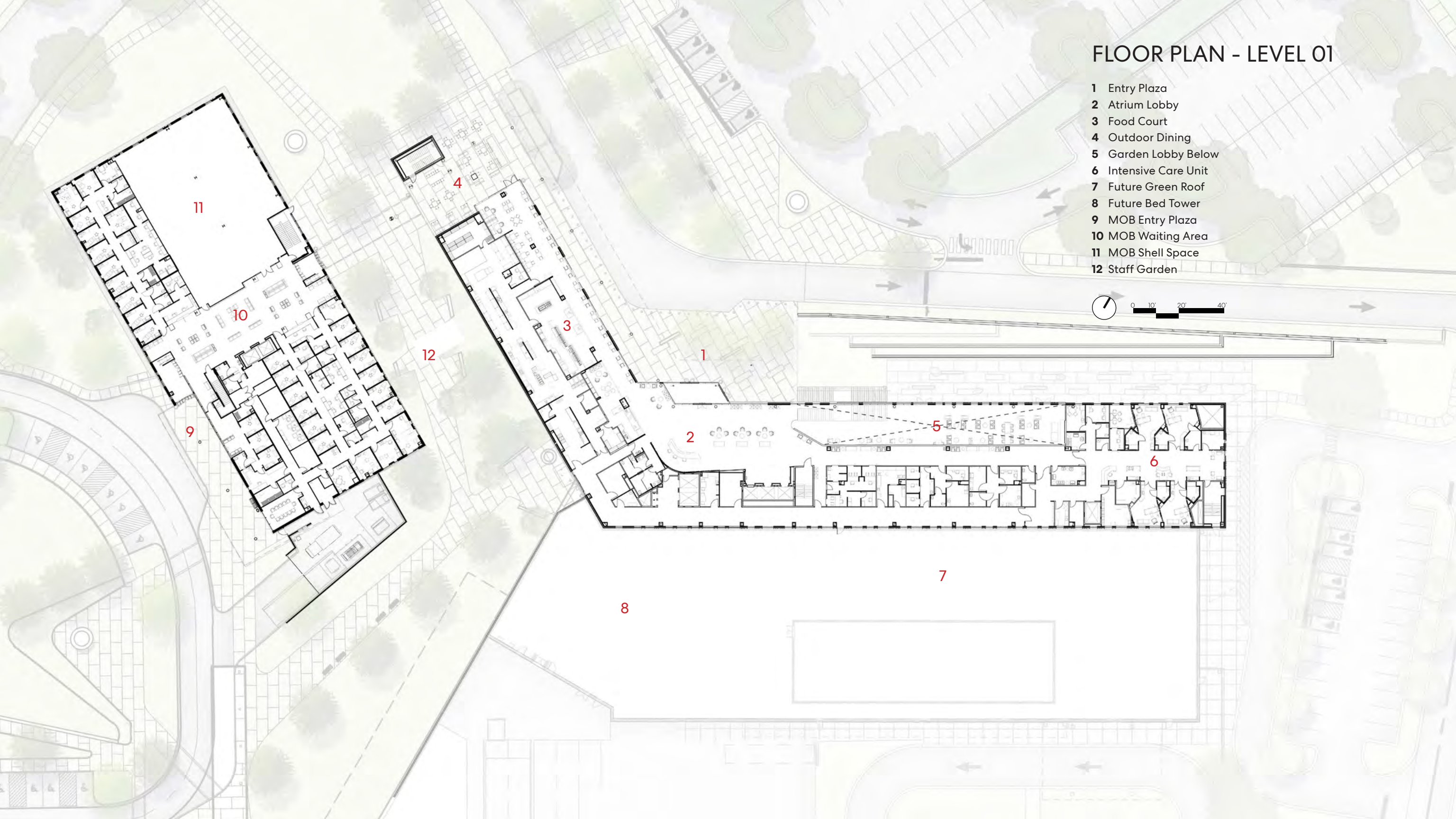

FLOOR PLAN - LEVEL 02

- 1 Atrium
- 2 Waiting Area
- 3 Community Room
- 4 Administration
- 5 Bridge to MOB
- 6 Patient Care Unit
- 7 Future Bed Tower
- 8 MOB Waiting Area

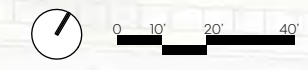

7



North Carolina's Piedmont region is characterized by rolling hills and small farming plats imprinted with the short furrows of contour ploughing. These agrarian textures and the reddish-brown soil inspire the earth-toned composition of this new hospital campus's connection with its rural context.



Outdoor Dining



Main Entry Plaza



Atrium Health
Union West
A facility of Atrium Health Union

Atrium Lobby



Garden Lobby



The typical healthcare experience can be defined as impersonal, transactional, procedural, and expensive. This project moves the healthcare experience to one that is intimate, caring, and outcome-focused. It's supported by architecture that elevates the healthcare journey and contributes attributes of sustenance and hospitality to medical design.



MOB Front Entry

