

53267353

Fort Fisher Visitor Center
Kure Beach, NC





EXISTING CONDITIONS

- 1 Original Extent of Fort
- 2 Atlantic Ocean
- 3 1865 Shoreline
- 4 Cape Fear River
- 5 World War II Runway



EXISTING CONDITIONS

- 1 Atlantic Ocean
- 2 Cape Fear River
- 3 Existing Earthworks
- 4 WW II Airstrip
- 5 Existing Visitor Center
- 6 Existing Parking

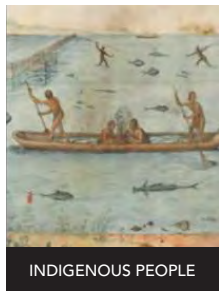

INDIGENOUS PEOPLE



A NATION AT WAR



BUILDING THE FORT

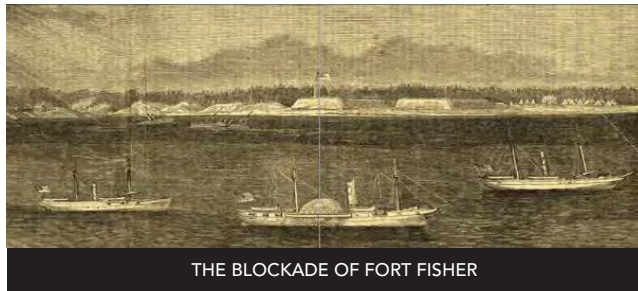

THE BLOCKADE OF FORT FISHER

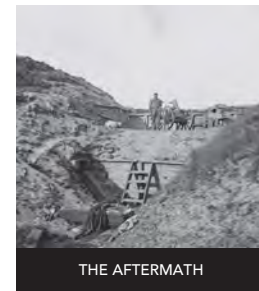

THE AFTERMATH



REMAKING THE SOUTH



WOMEN PILOTS DURING WWII

7,000 BC ◀ ▶ 1942

HISTORY OF SITE AND FORT FISHER

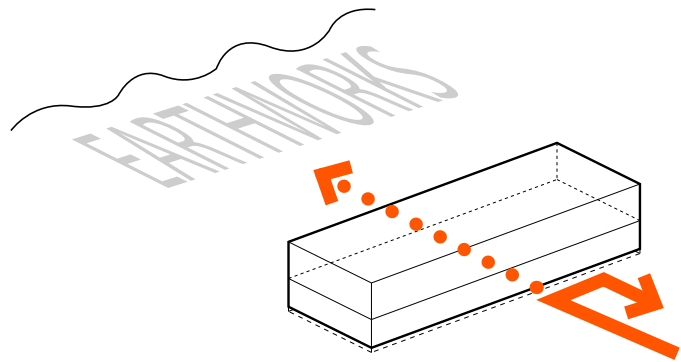
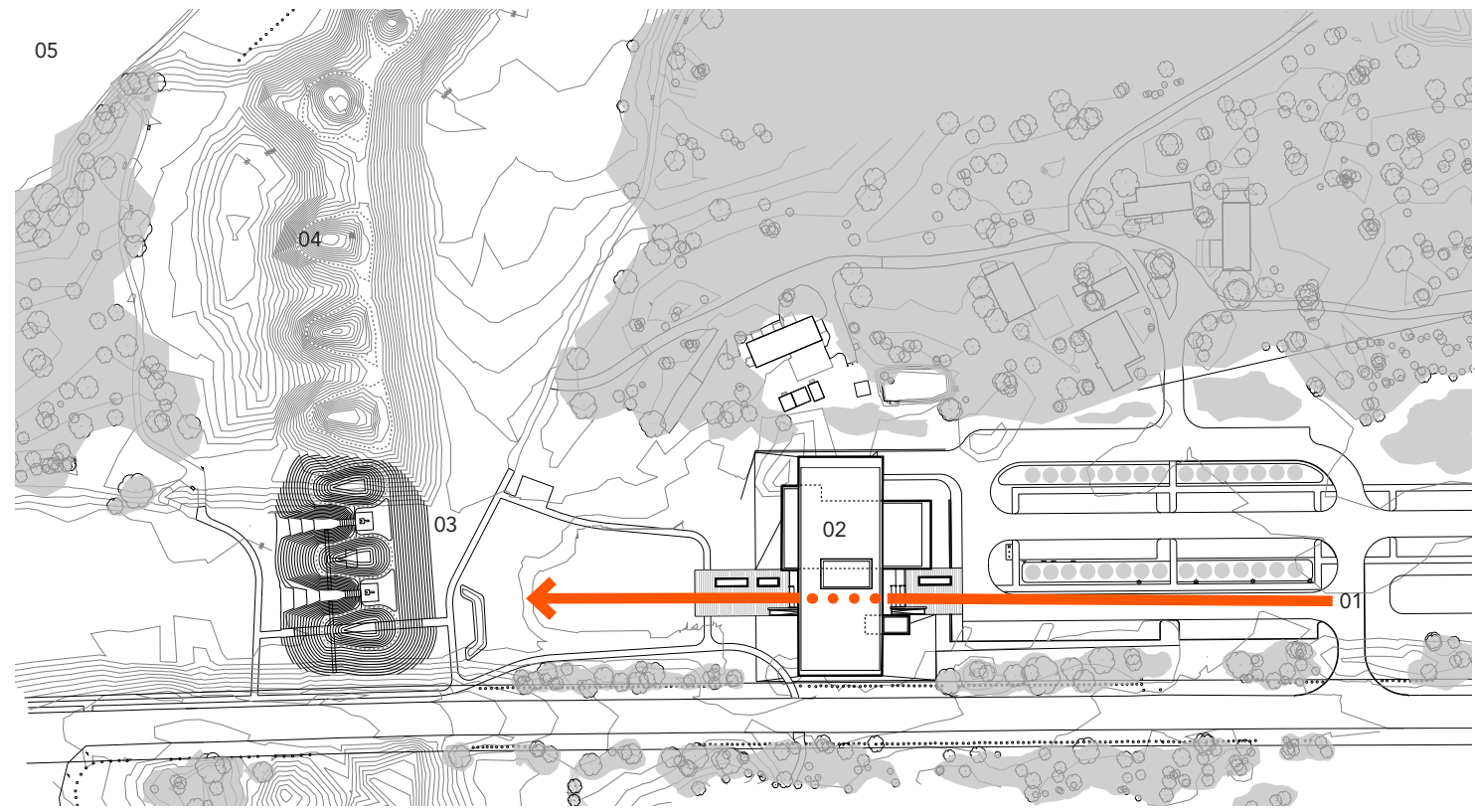

01
stacked volumes interrupt views/access to earthworks

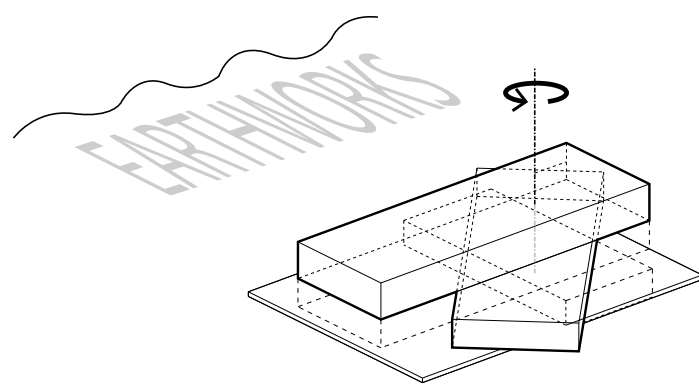

02
rotate lower program until perpendicular to earthworks

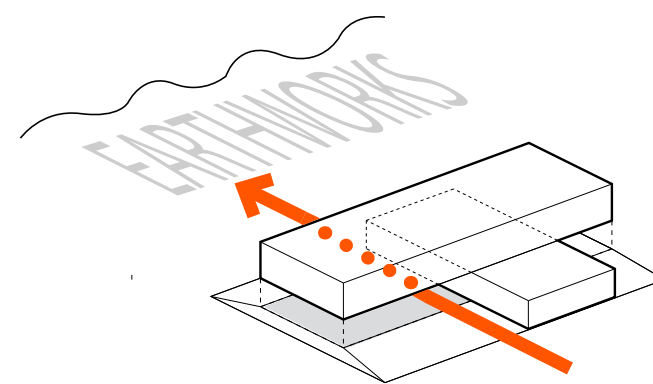

03
clear visibility and access upon arrival + covered outdoor space

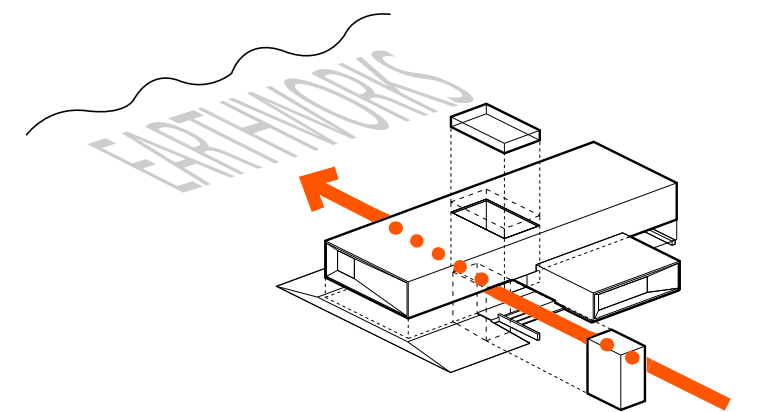

04
clerestory + stair tower composite massing

VIEW

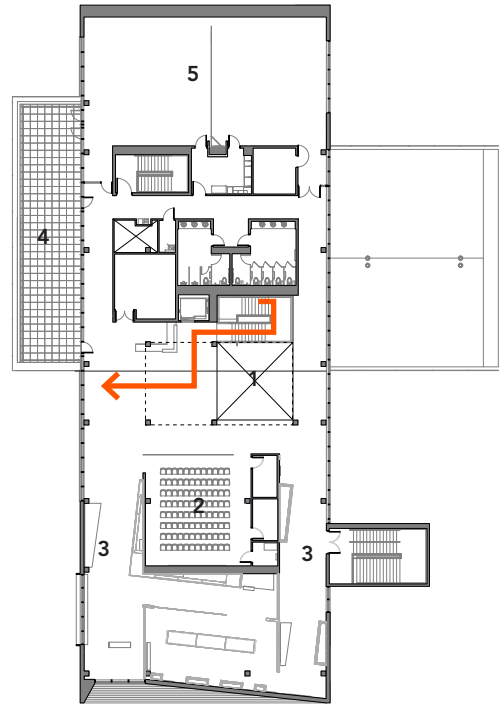

⊖ SECOND FLOOR PLAN

- 1 Open to Below
- 2 Orientation Room
- 3 Exhibit Area
- 4 Balcony
- 5 Multipurpose Room

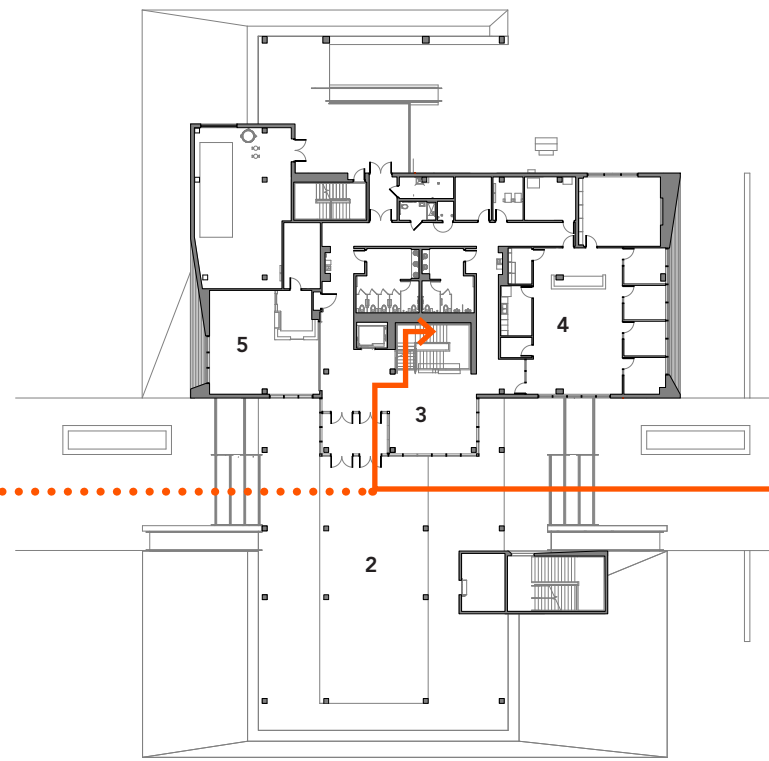

⊖ FIRST FLOOR PLAN

- 1 Approach from Parking
- 2 Group Staging Area
- 3 Lobby
- 4 Offices
- 5 Gift Shop
- 6 To Earthworks

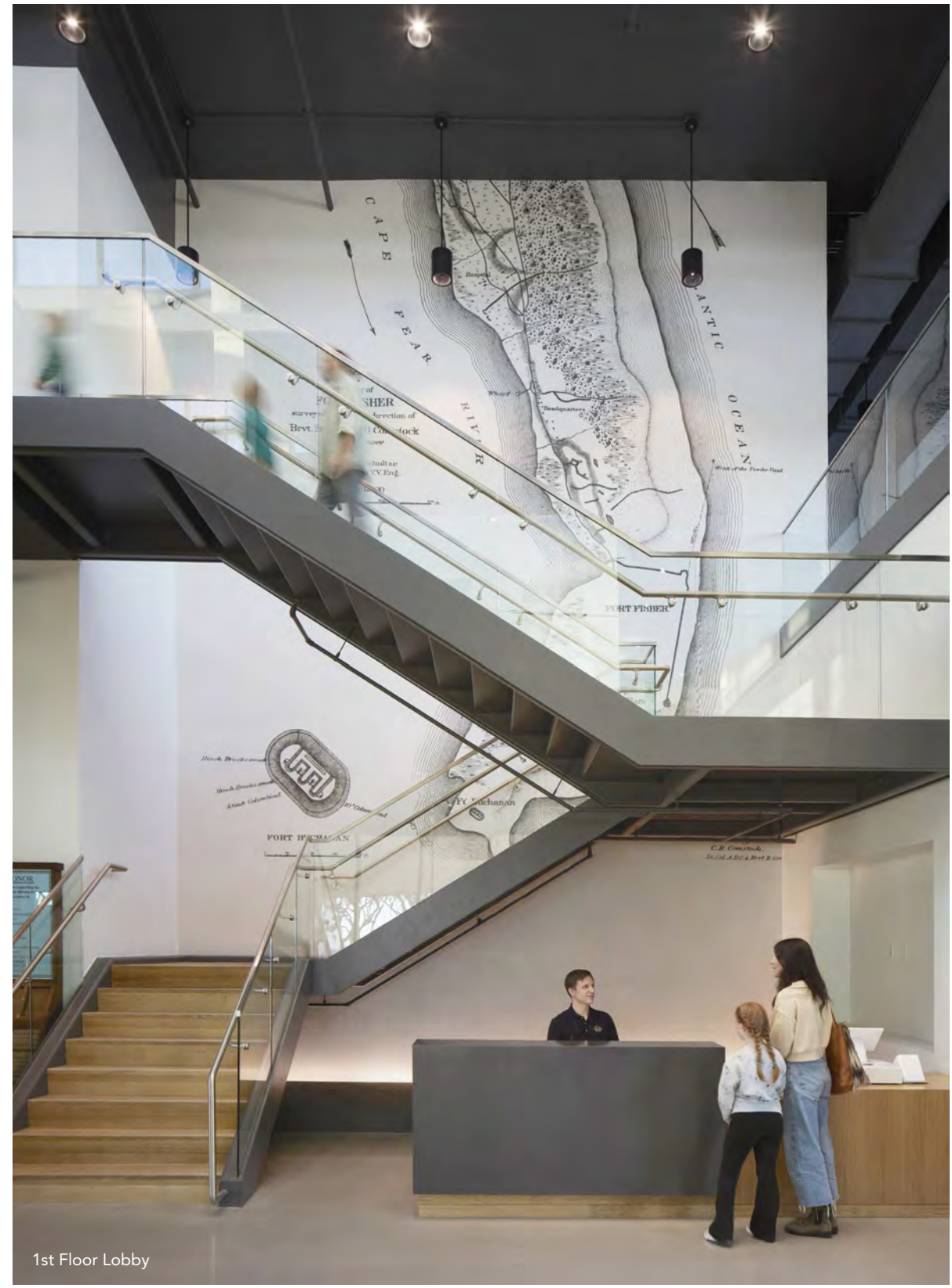

1st Floor Lobby





Staging Area with view to Earthworks



East Elevation

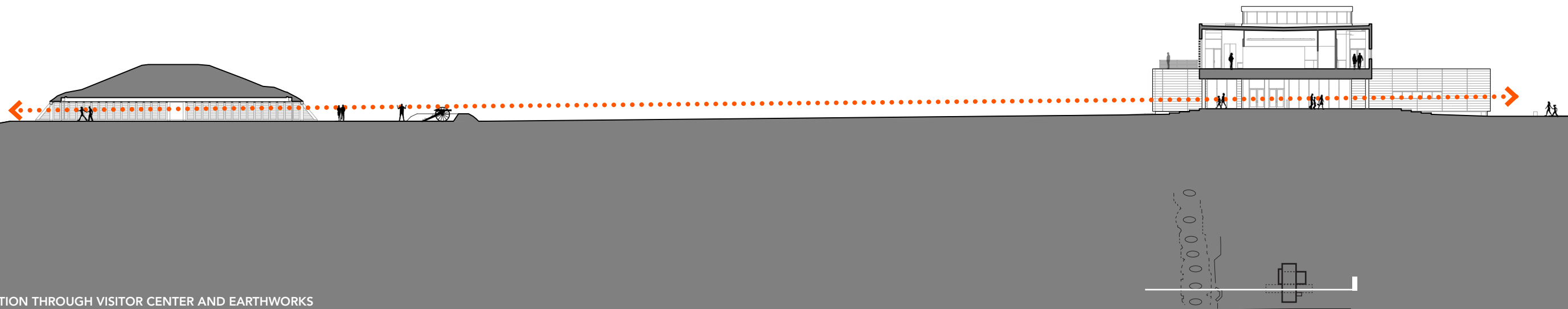

NORTH - SOUTH SECTION THROUGH VISITOR CENTER AND EARTHWORKS



View from Southeast



Staging Area with view to Ocean



View from Southwest

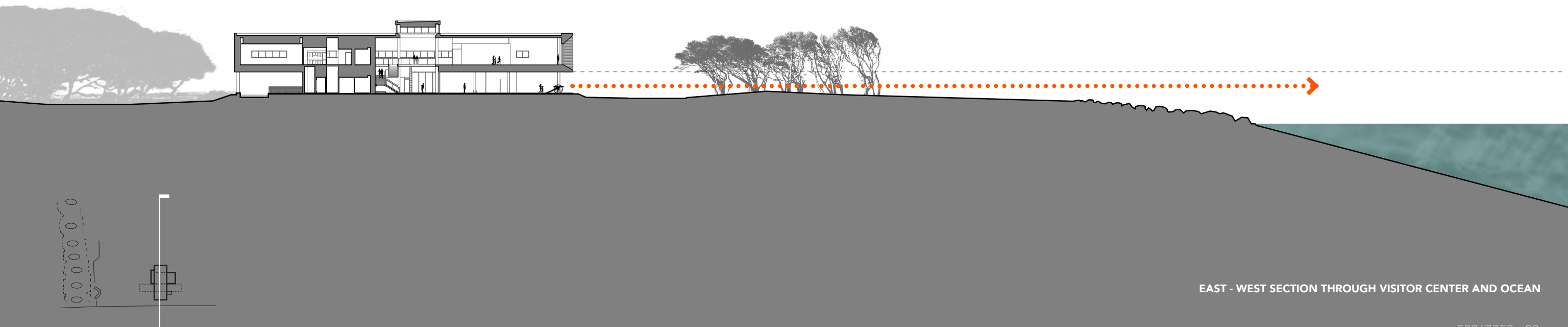

EAST - WEST SECTION THROUGH VISITOR CENTER AND OCEAN



Atrium with view to Earthworks

FC
surveyed
Brvt. Brig
Ott
Pr
Engraved at



Exhibit Area with view to Ocean



Exhibit Area - Table of Iron



View to Ocean



View from Northeast



South Elevation