

**53271699**



## ■ Sossusvlei Visitors Center

Sossusvlei, a UNESCO World Heritage site in Namibia, is renowned for its striking desert landscape and massive dunes reaching up to 300 meters, making it a sought-after destination for photographers. The park faces often above 100 degrees and lacks natural shelters for visitors. The client, holding a 25-year concession to manage the park, tasked the architect with designing a visitors center that will help protect and promote this park and showcase the wonders of this valley.

The project's primary purpose is to protect the delicate dune environment by regulating the shuttle transportation throughout the park, reducing the environmental damage to the dune caused by self-driving visitors. Additional project objectives include providing modern restroom facilities and creating an energy-efficient structure. Visually, the building integrates seamlessly with its surroundings, drawing inspiration from the flowing shapes of the dunes.

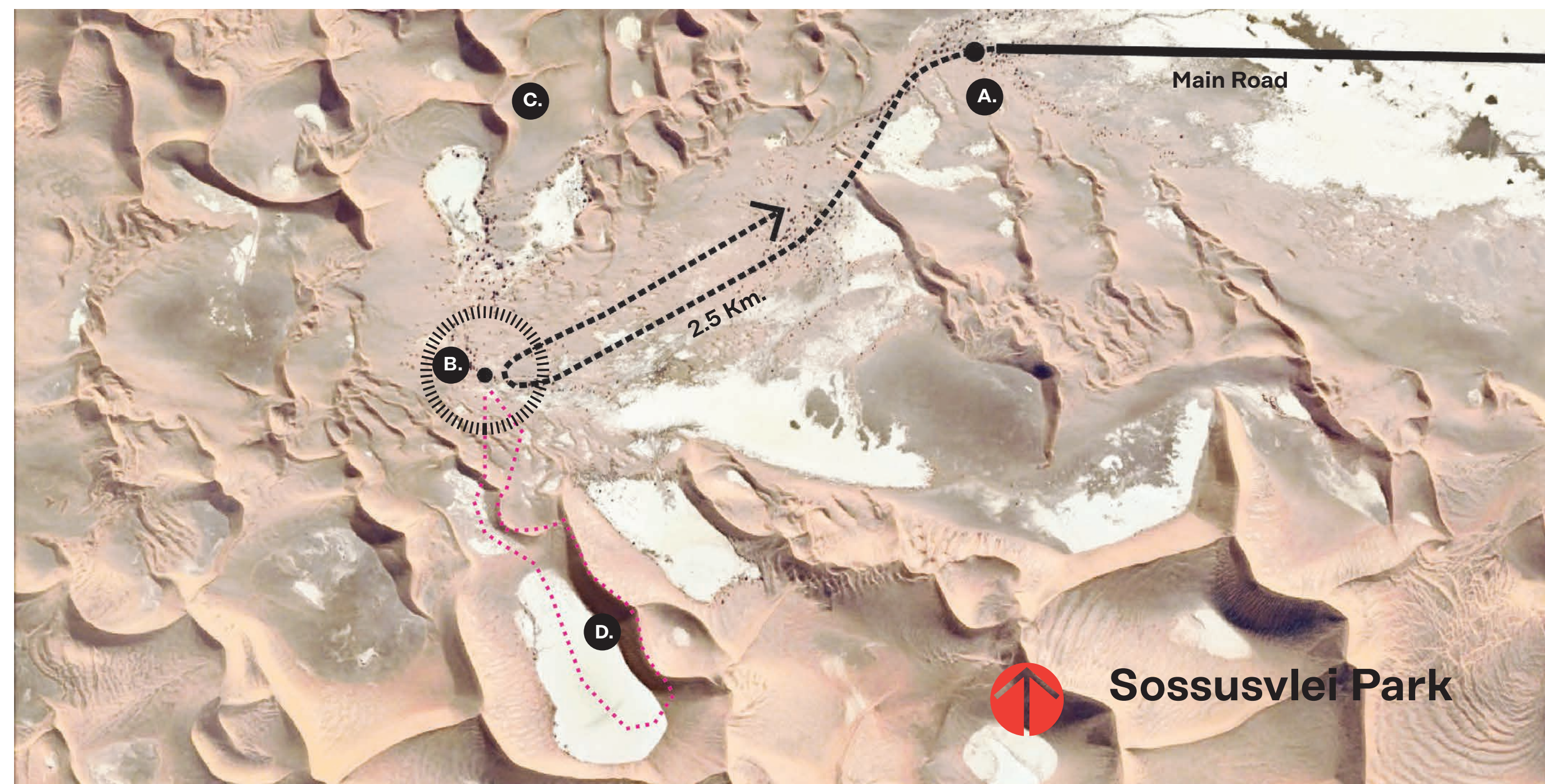
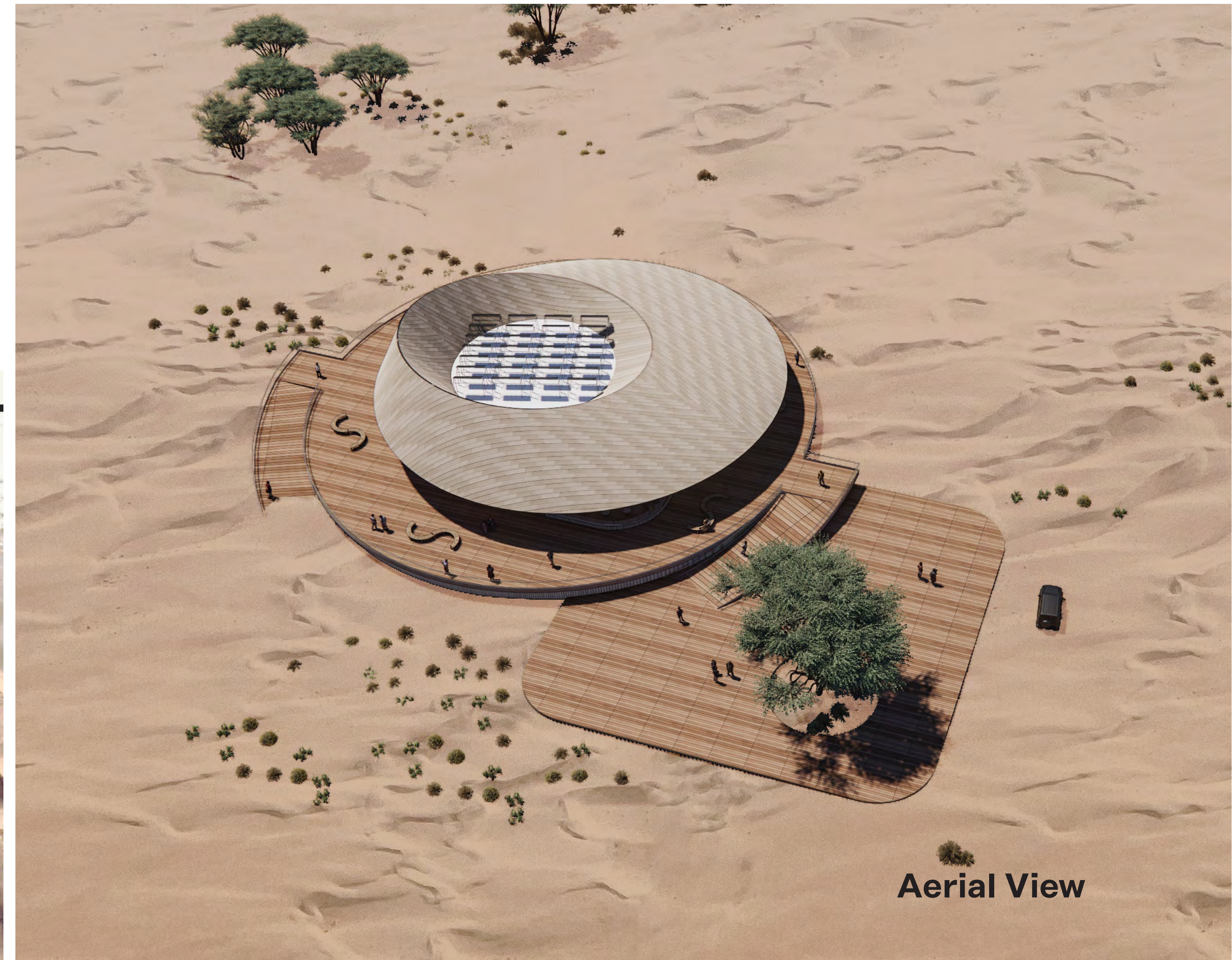
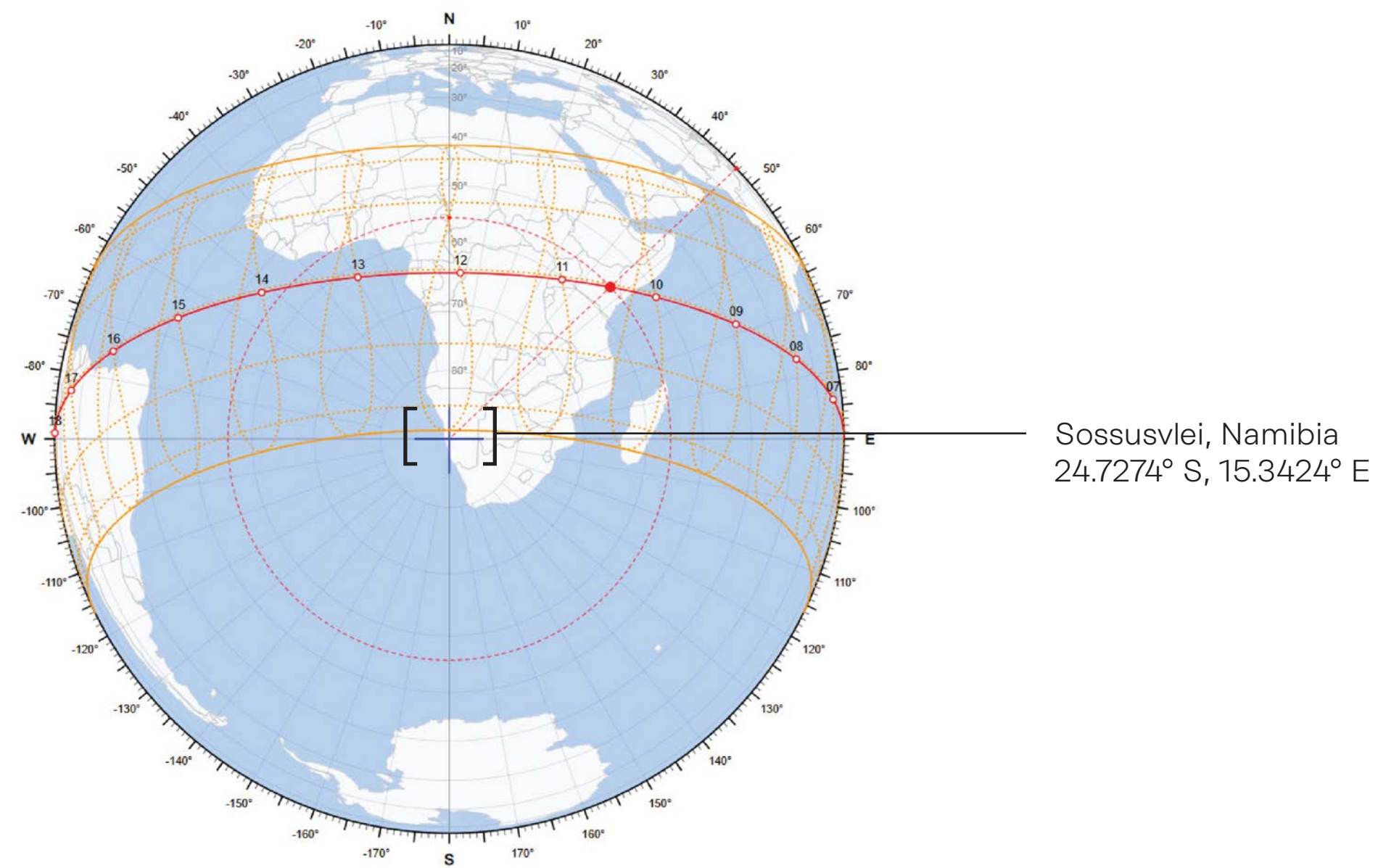

- Shuttle Route
- South (Deadvlei) Hiking Trail
- A.** Park Registration & Shuttles
- B.** Visitor's Center
- C.** Big Mama Dune (North Valley)
- D.** Big Daddy Dune & Deadvlei (South Valley)

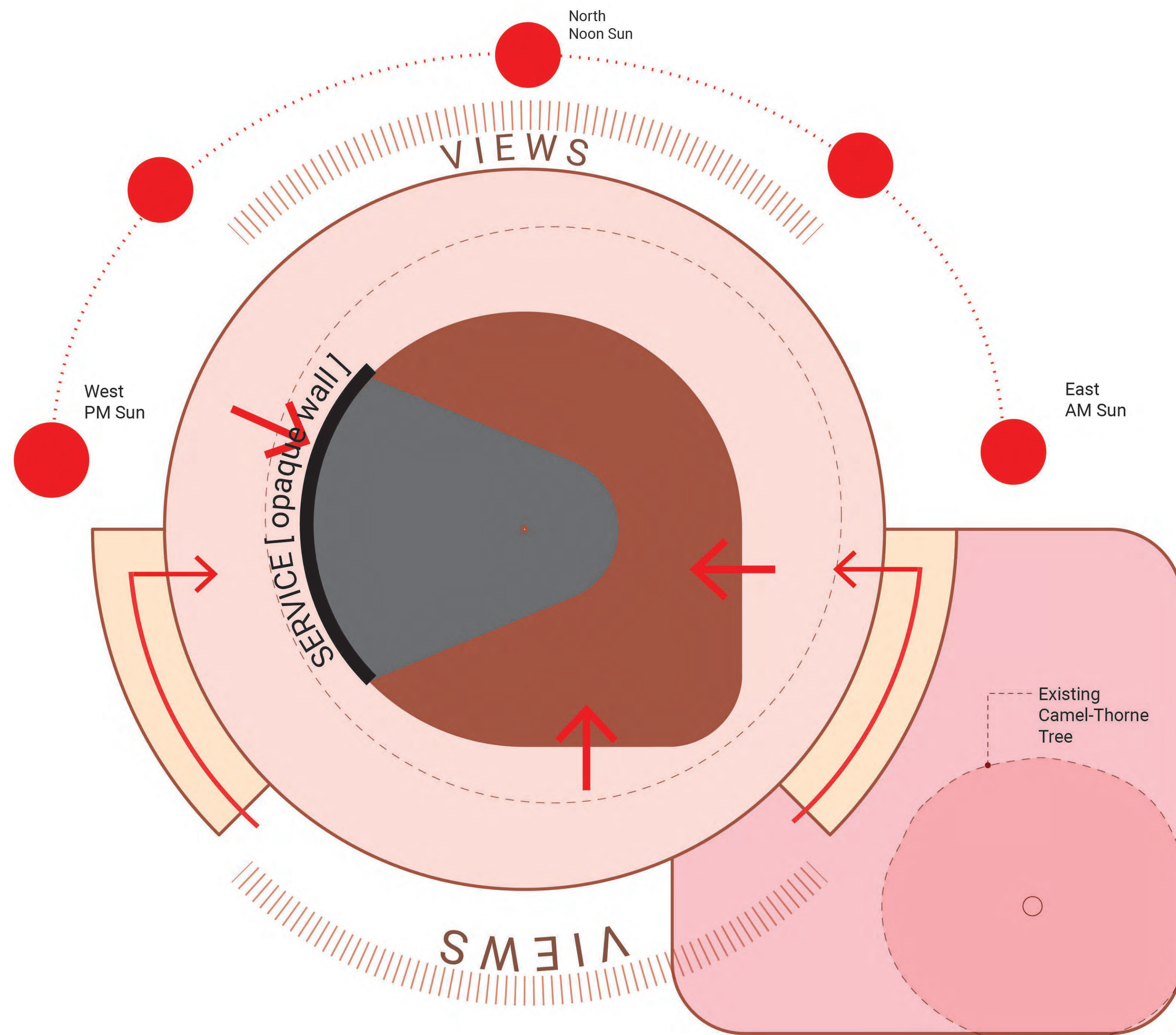

### Program

- Support Areas
- Public Area
- Observation Deck
- Access Ramps
- Arrivals & Departures Platform
- Building Access

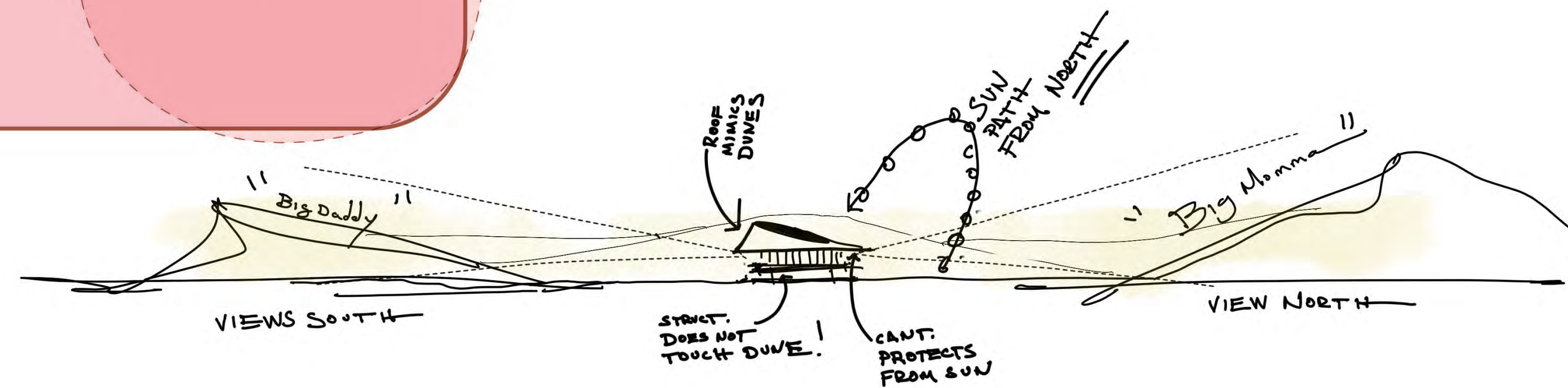

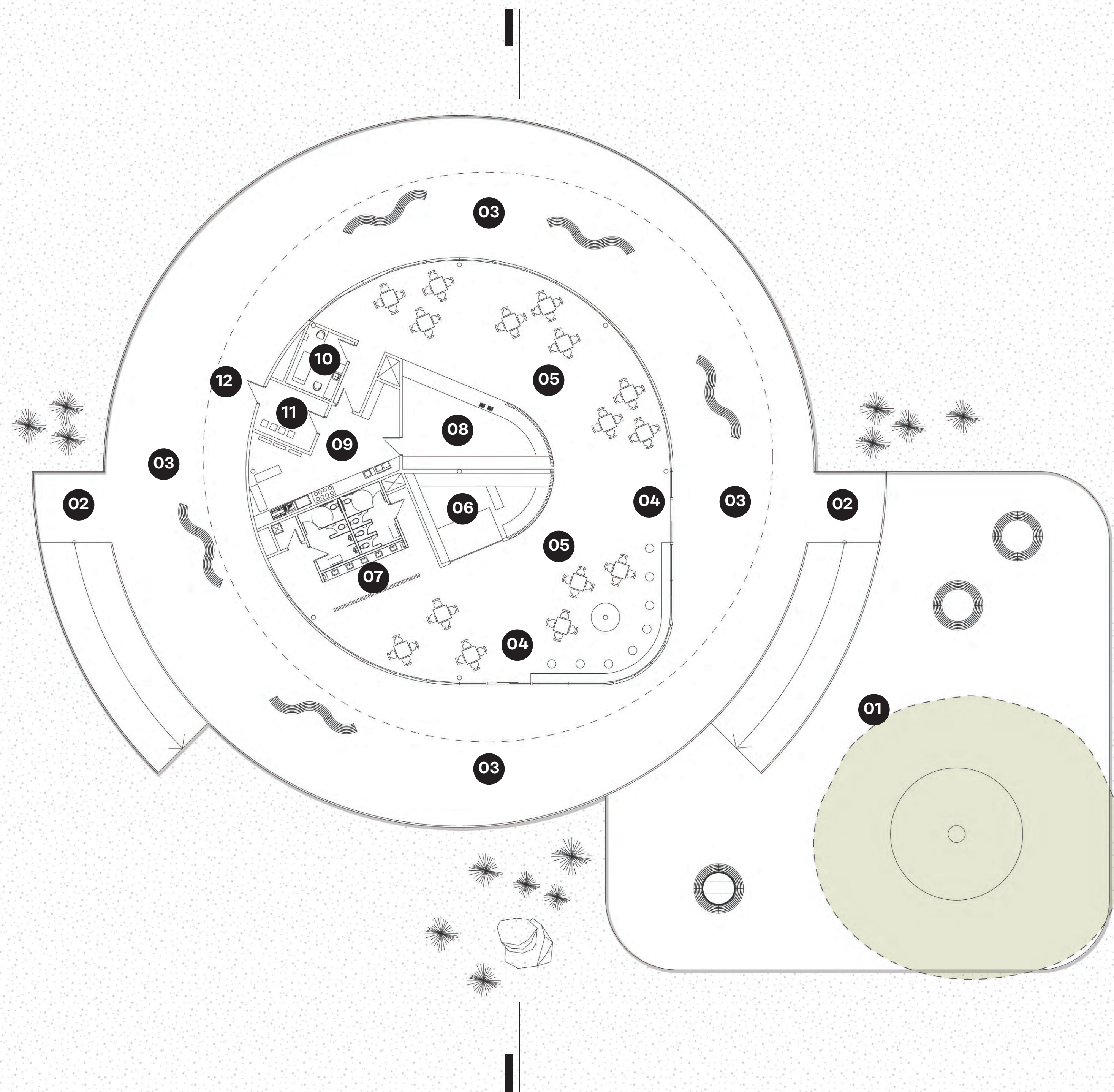

## Floor Plans



- 01** Arrivals & Departures Platform
- 02** Ramp
- 03** Observatory Deck
- 04** Entrance
- 05** Dining & Lounge
- 06** Souvenir Shop
- 07** Restrooms
- 08** Concessions
- 09** Kitchen & Storage Area
- 10** Medical Room
- 11** Trash
- 12** Service Entry

750 m<sup>2</sup> [8,072 ft<sup>2</sup>] Heated Space  
 2050 m<sup>2</sup> [22,066 ft<sup>2</sup>] Unheated Exterior Deck Spaces

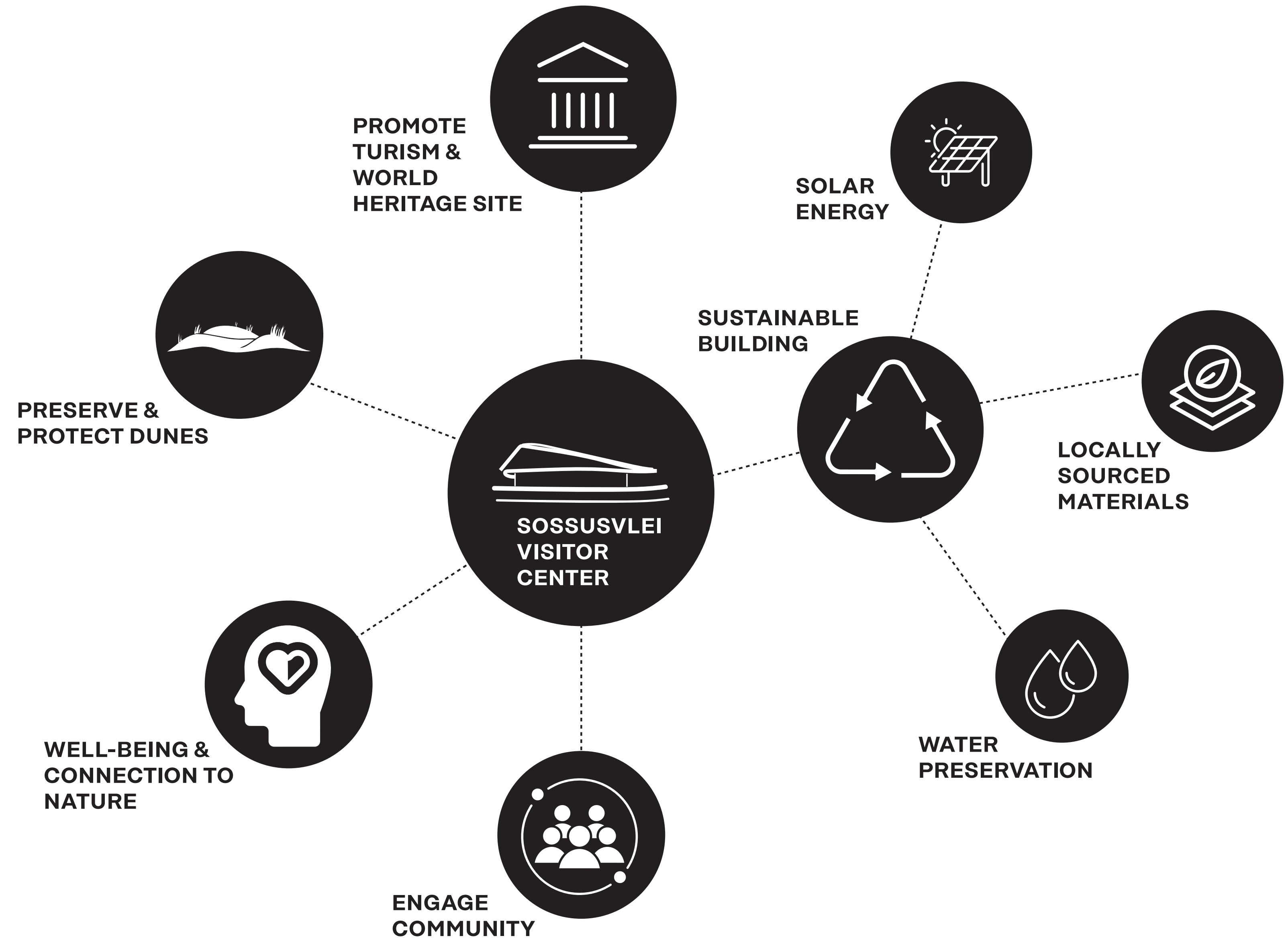

**Project's Goals**



Access ■

■ Arrivals & Departures Platform Deck

53271699-07



■ South-West Elevation

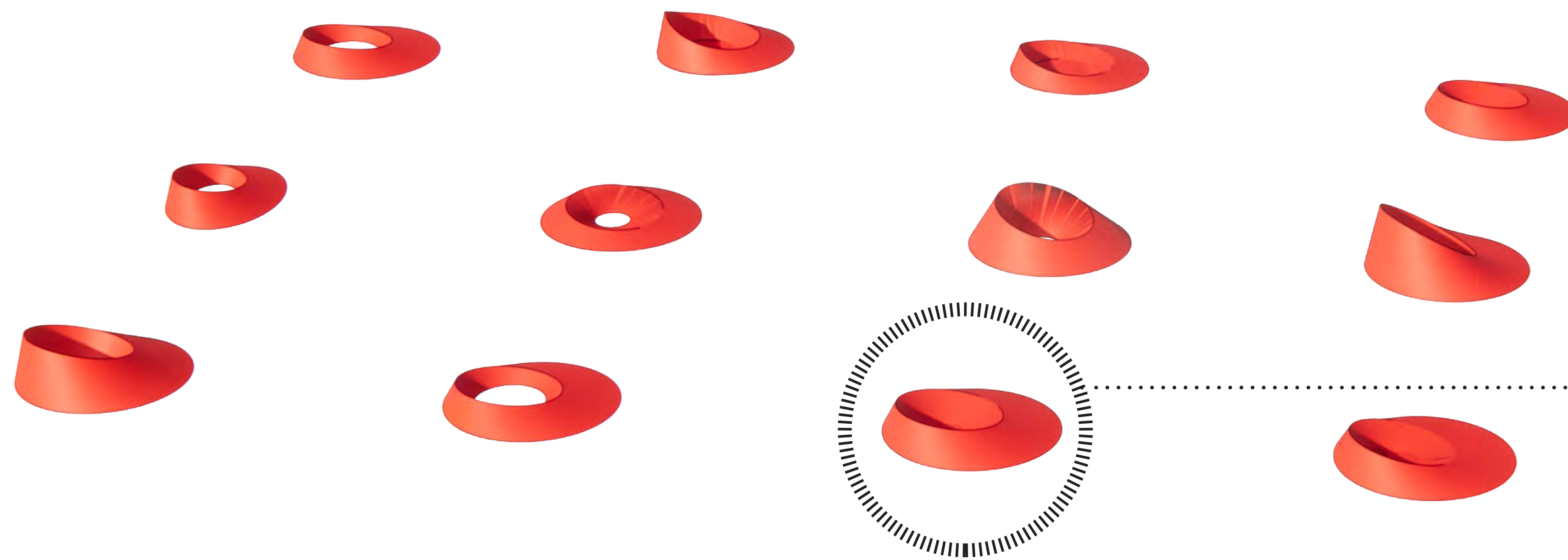

Massing Studies  
■ Inspiration

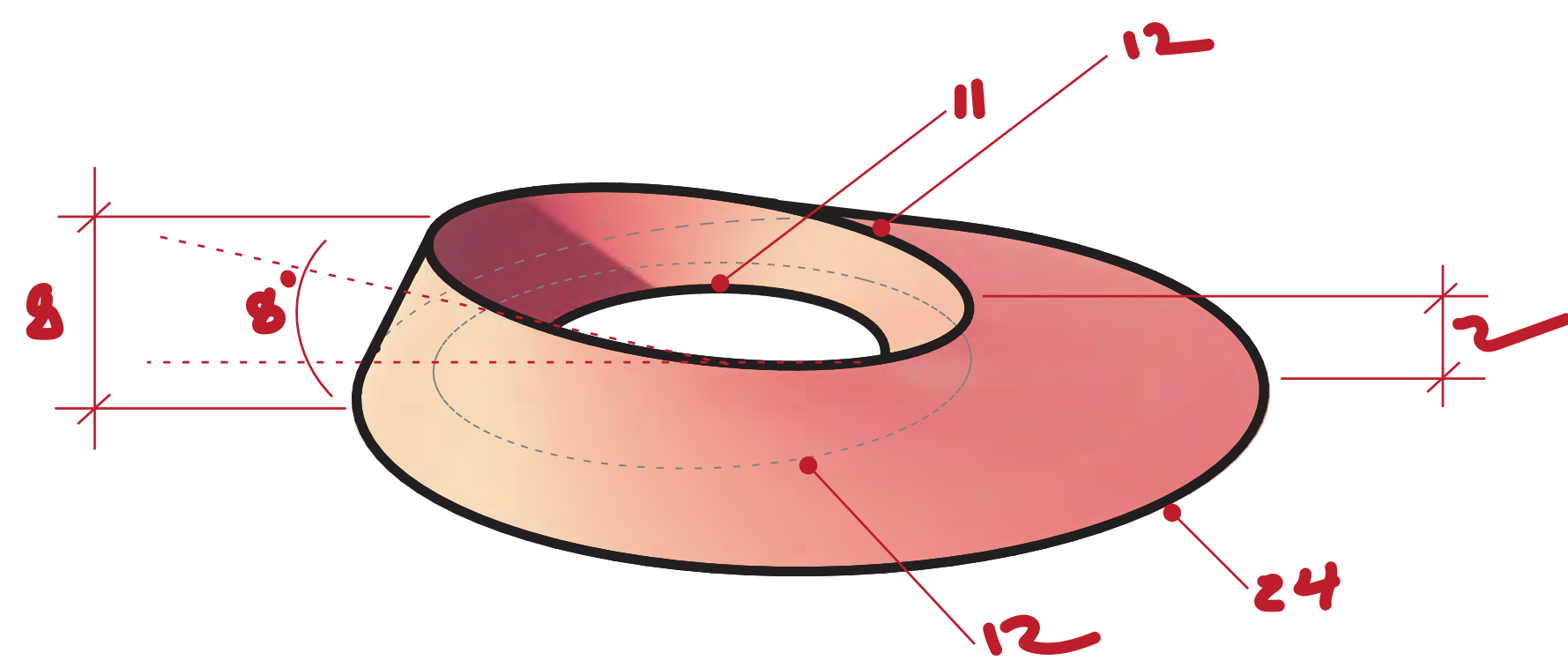

Dune Formation

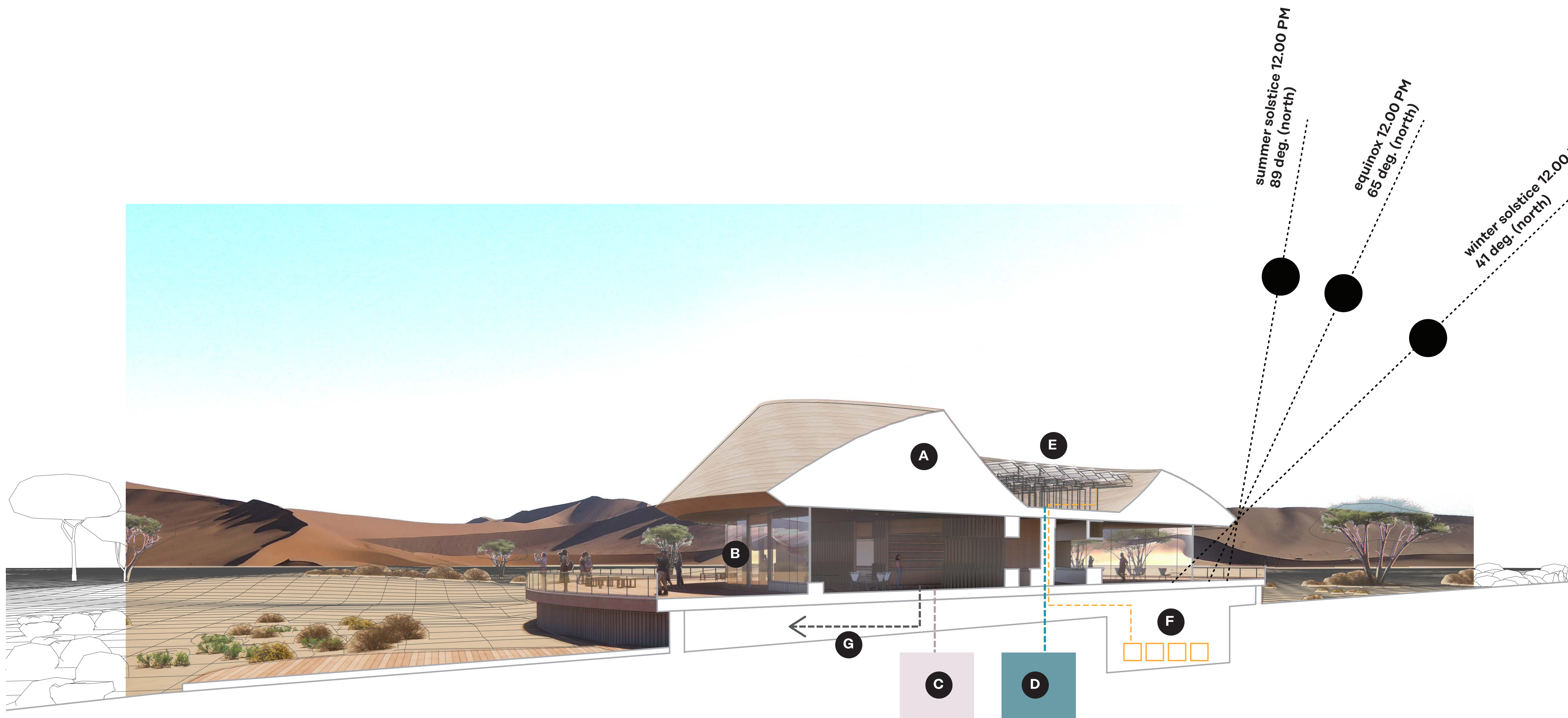

### Section Perspective

- A** R-52 Roof Insulation
- B** Triple Pane Glass
- C** Grey Water System
- D** Roof Harvested Water Cistern
- E** Solar Panels
- F** Battery Storage & Inverter
- G** Sewer Line to Septic Tank [60 m West of Building]

# 360 Views

Panoramic Views to the Sossusvlei Valley



Views to Big Daddy Dune  
[ South Valley ]



Views to Big Momma Dune  
[ North Valley ]



## ■ Visitors Center

Uninterrupted sweeping views to the south and north valleys, are a staple feature of the project. Being able to offer a connection to the outside while creating a comfortable envelope necessary for the project's success.



■ **Dynamic Impression,  
Serene Stance**

View from the North overlooking the south dune valley